

Architectural
Concepts

ACCL80SC

Barn Door Installation Instructions

78 3/4" (2 M) Track Length (pictured)

Dual-Soft Close

MINIMUM door size for application is
33 1/2" wide

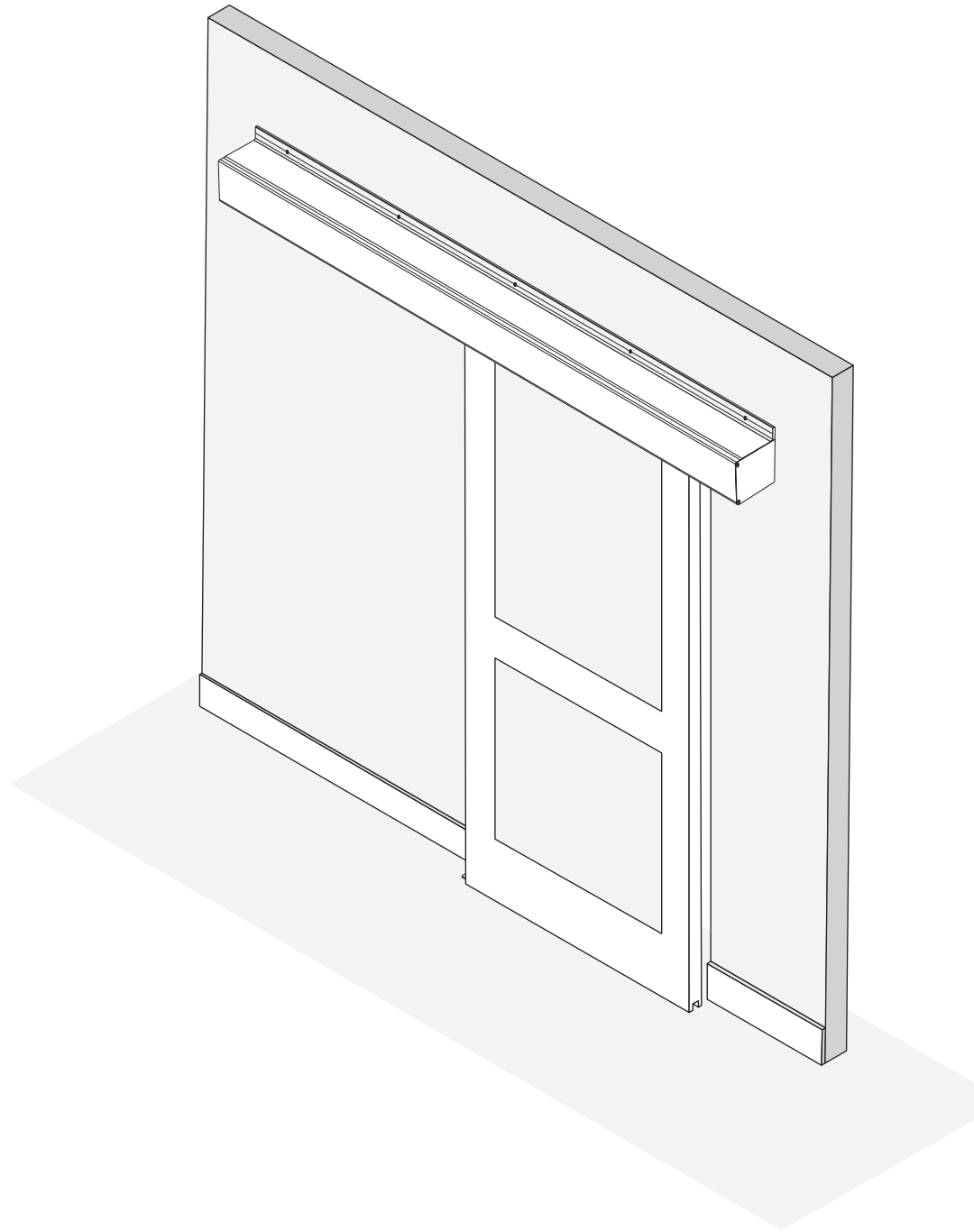

HARDWARE INCLUDED

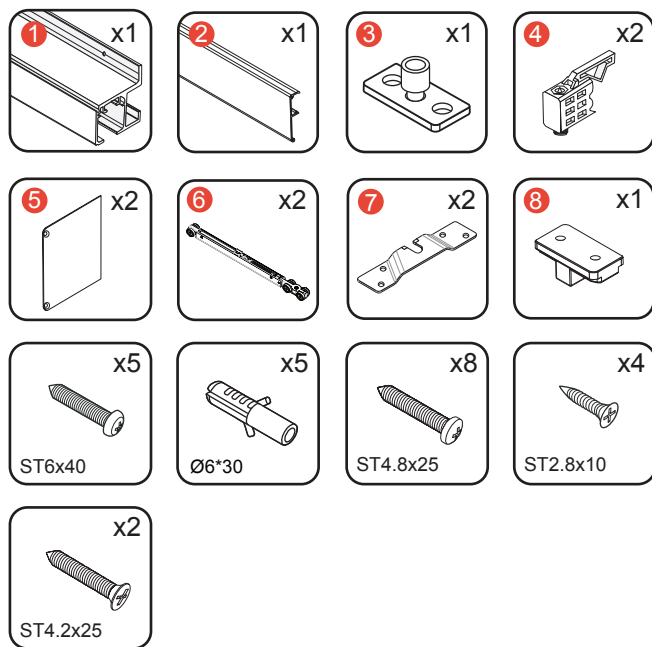

2M

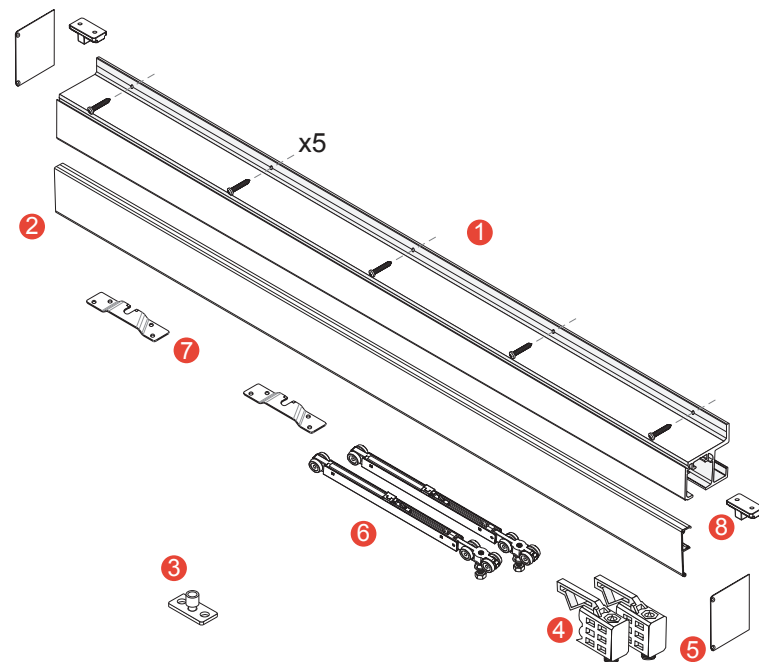

2.5M

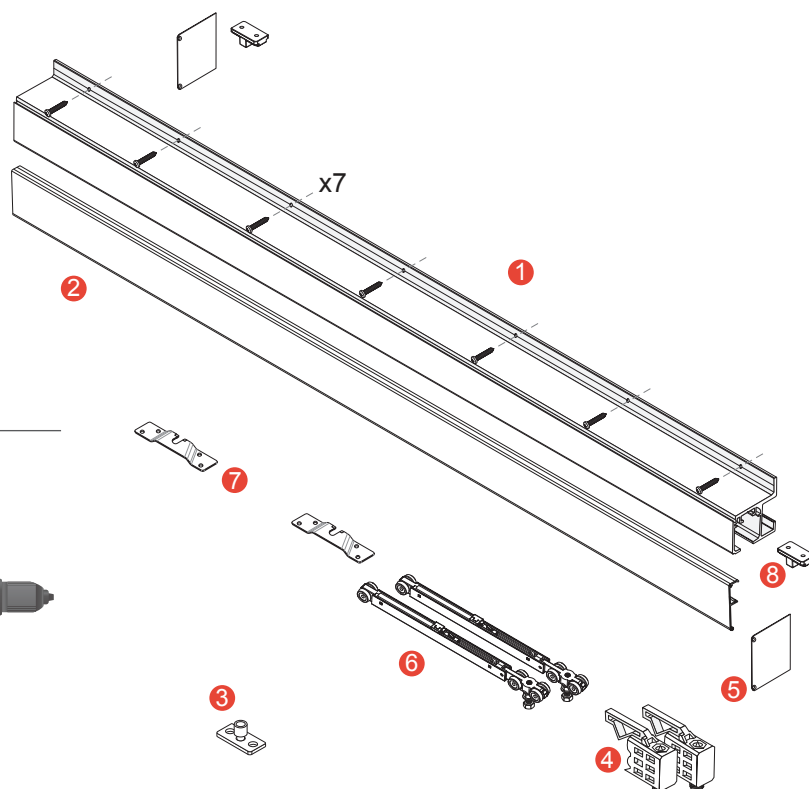

TOOLS NEEDED

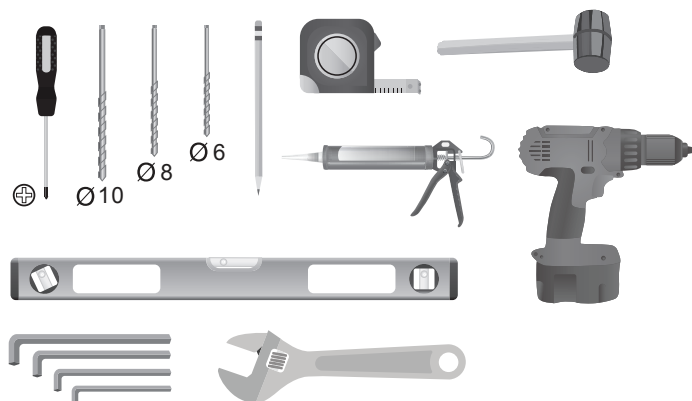

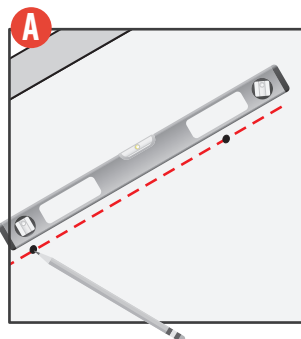
Step 1**A.1**

Measure for position of wall mounts that are 16" apart. Ensure marks are level

Track should be fastened to solid wood or steel blocking for support

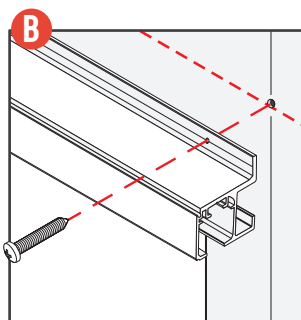
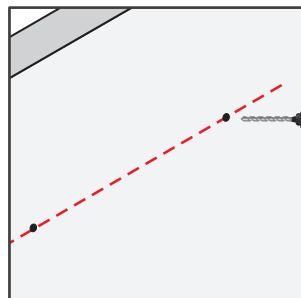
**B.1**

Mount track with the 5 included screws (7 screws in the 2.5M track)

ONLY install to solid blocking

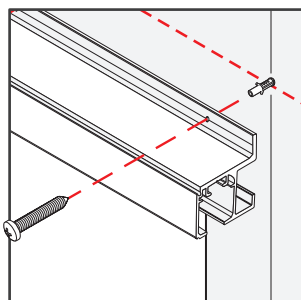
**B.2**

If the field installer determines masonry/drywall anchors are needed ensure the anchors are appropriate for the application

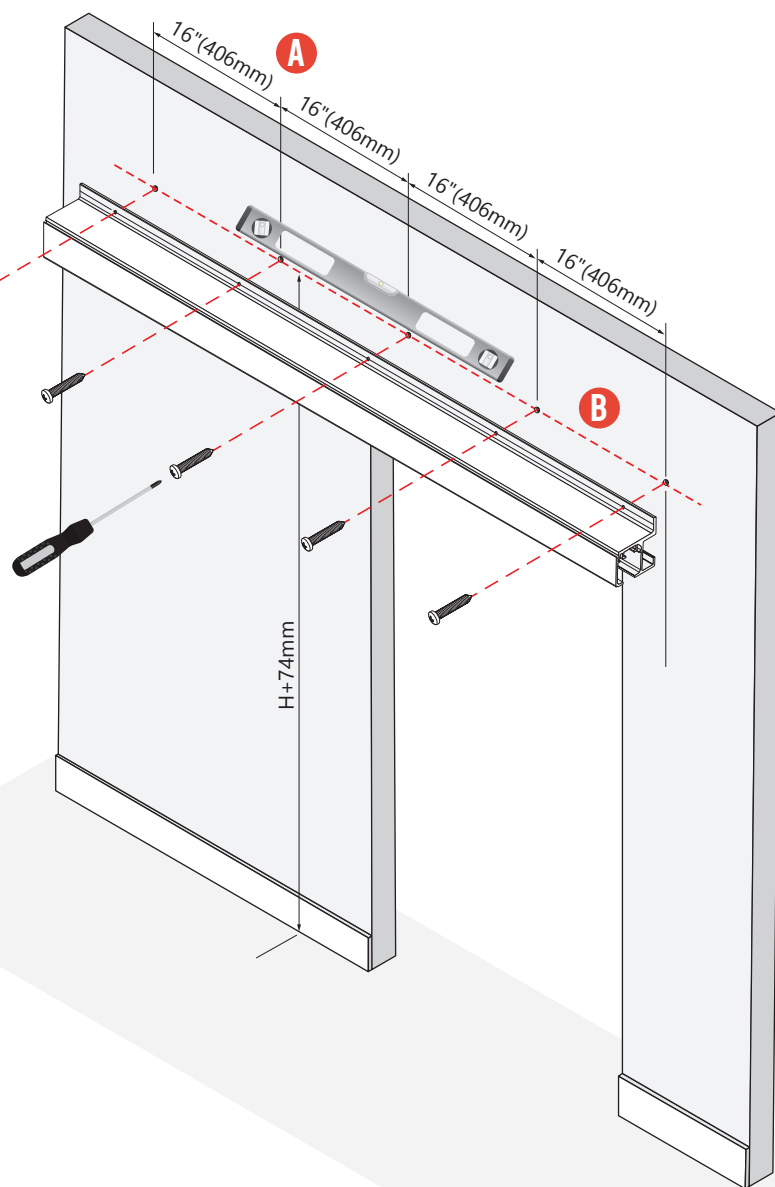
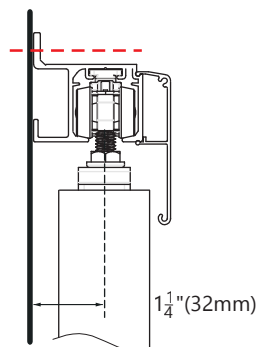

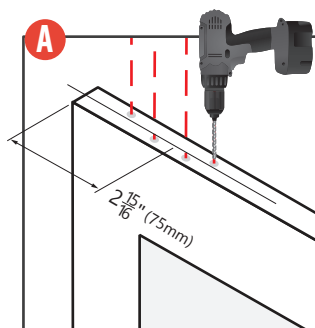
Step 2**A.1**

Measure and drill holes to mount trolley's on top of door. 75mm to center of bracket

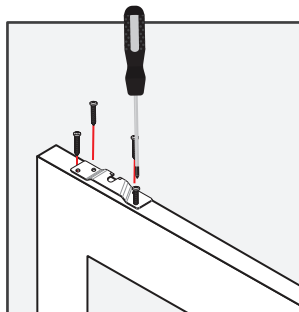
**A.2**

Mount left bracket to top of door

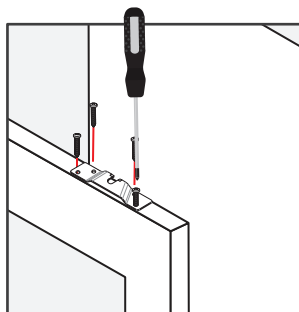
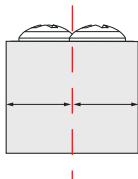
**A.3**

Mount right bracket to top of door

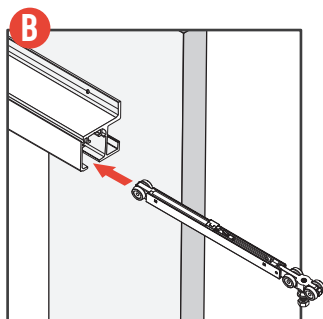
**B.1**

Insert soft close door mounts into track

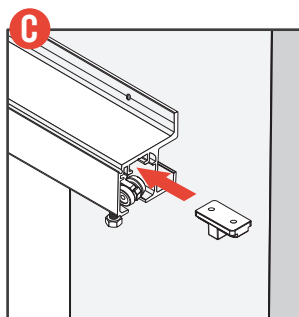
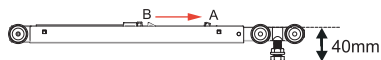
**C.1**

Slide trigger into top of track

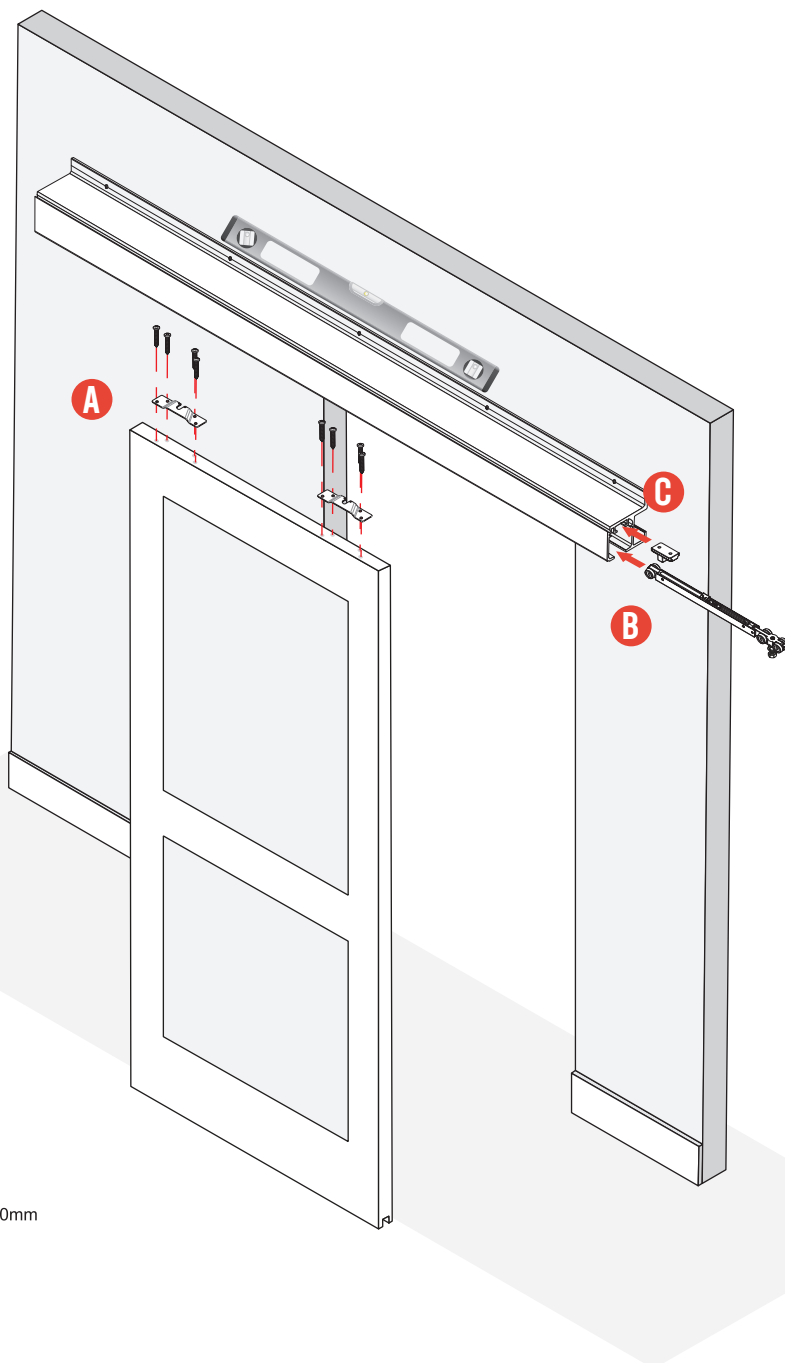

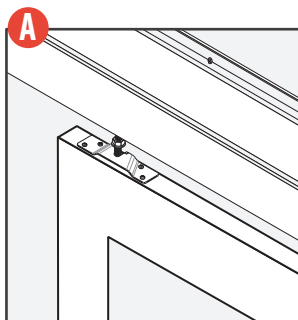
Step 3**A.1**

Mount door
Slide mounting plates
over exposed bolts
for connection to
hanger

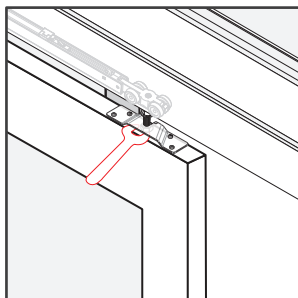
**A.2**

Tighten and adjust
for level

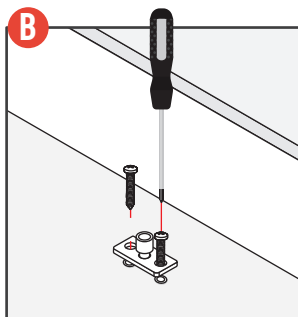
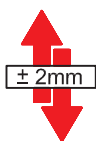
**B.1**

Position and mount
floor guide

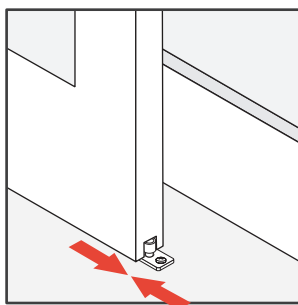
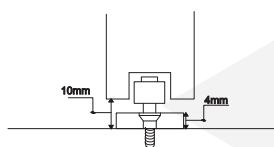
**B.2**

Ensure door
glides smoothly
back-and-forth
over floor guide

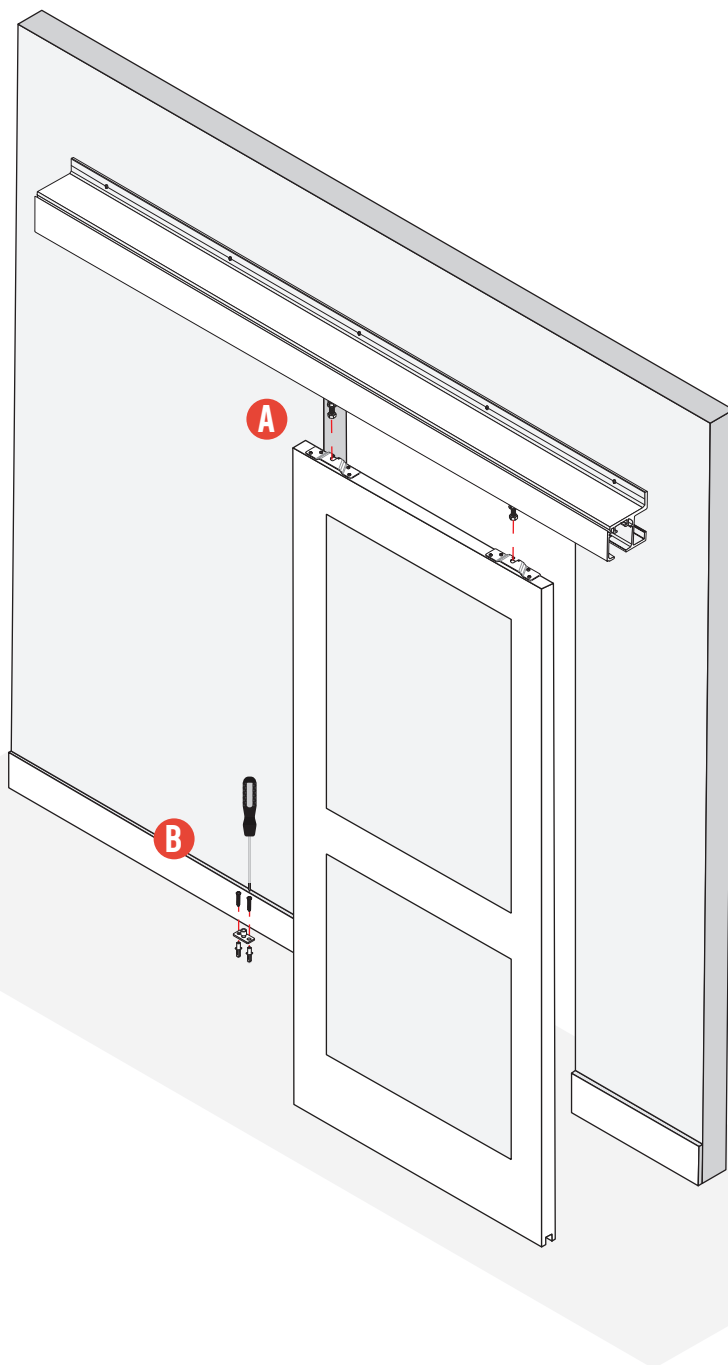

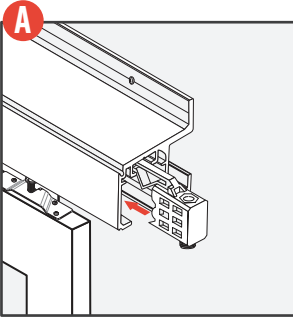
Step 4**A.1**

Insert security stop into end of track. Adjust for proper location to coincide with end of door travel after softclose completes function.

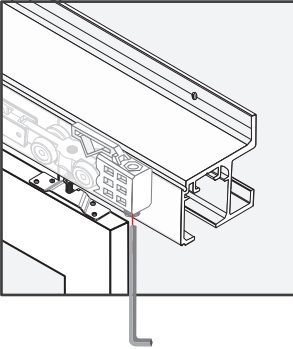
**A.2**

Use hex wrench to tighten

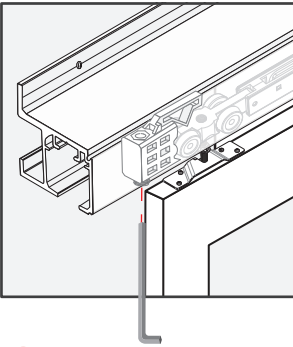
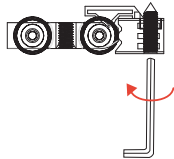
**A.3**

Use hex wrench to tighten

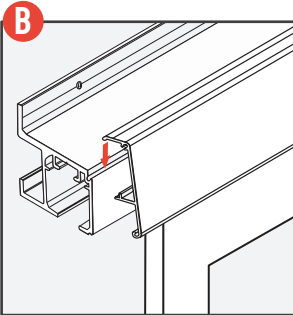
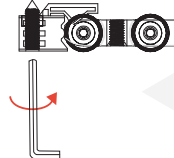
**B.1**

Attach valance
Insert top into space and press downward to snap in place over lower ledge of track

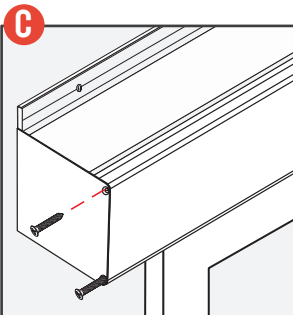
**C.1**

Fasten both endcaps with 2 screws

