

Architectural Concepts

NEWPORT

Barn Door Shower Enclosure Installation Instructions

76" OA Height
Fits Standard Opening Range of 54" - 60"

Customization Options Available

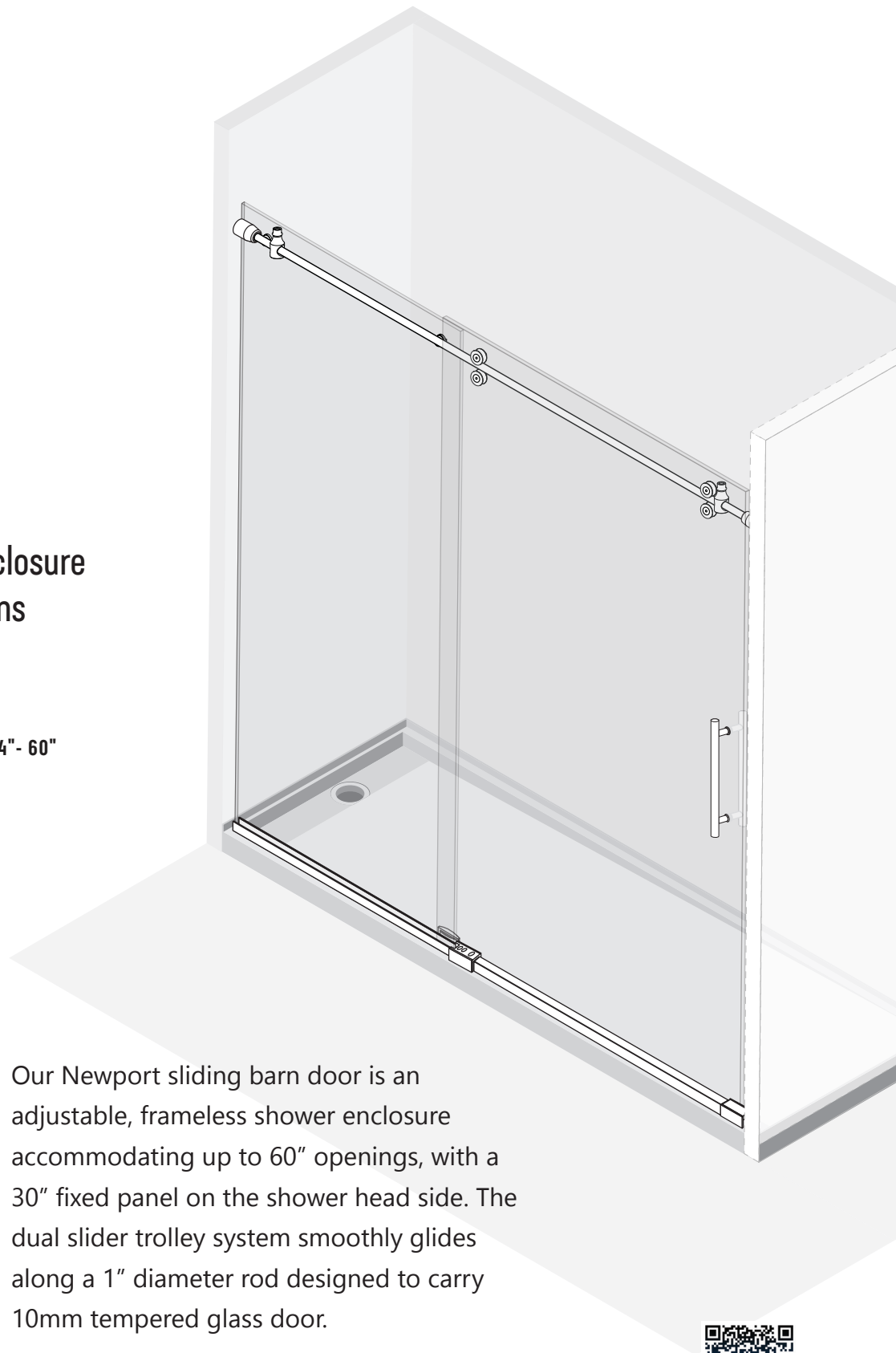

Our Newport sliding barn door is an adjustable, frameless shower enclosure accommodating up to 60" openings, with a 30" fixed panel on the shower head side. The dual slider trolley system smoothly glides along a 1" diameter rod designed to carry 10mm tempered glass door.



HARDWARE INCLUDED

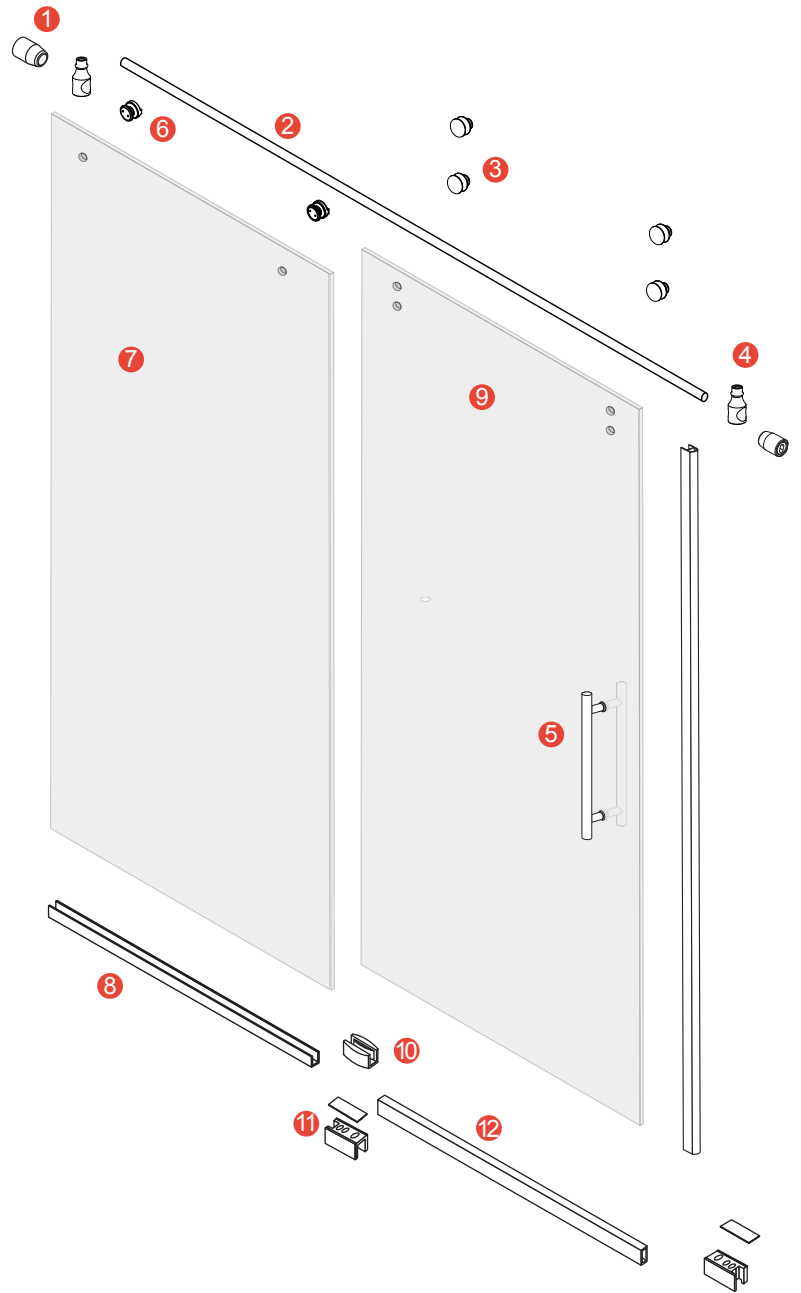
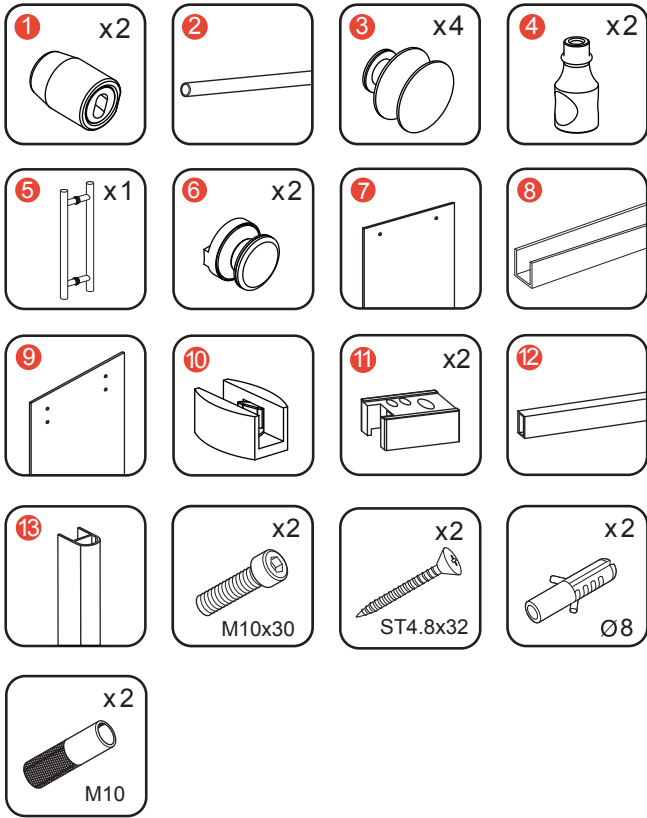

TOOLS NEEDED

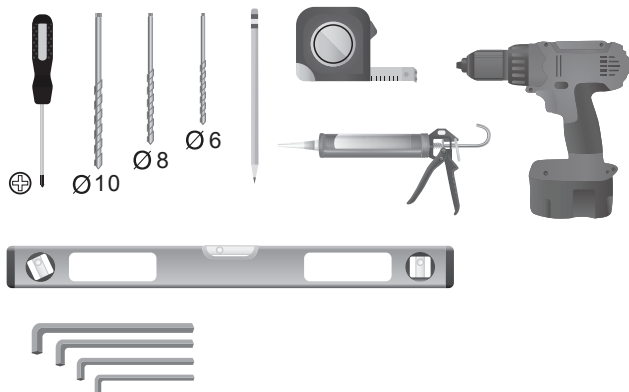

Step 1

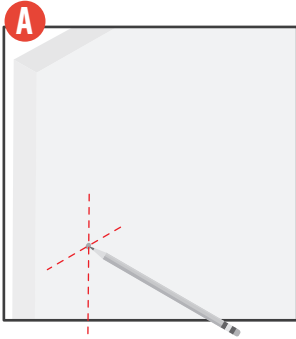

A.1
Measure.
Standard height H=76"
Hole location is
H – 2 3/4", mark hole
at 73 1/4"

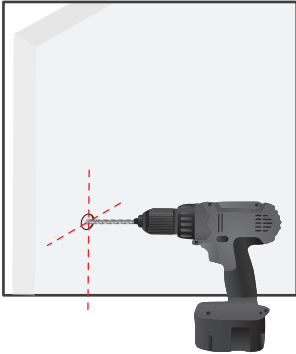

A.2
Drill holes. Note:
Hole should be 3/8"
(10mm) in diameter.
The mounting
bracket will give you
about a 1/4" play up
or down for the rod

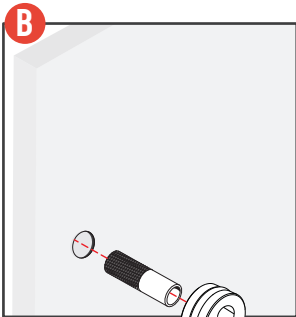

B.1
Ensure that there is
proper blocking for
expansion bolts to
mount through. If
not, the expansion
bolts will not grip.

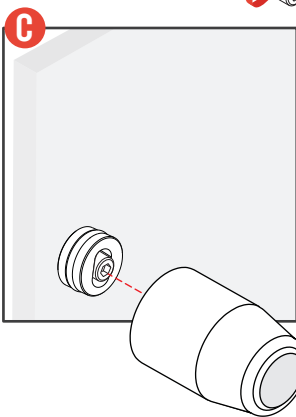

C.1
Attach rod mount

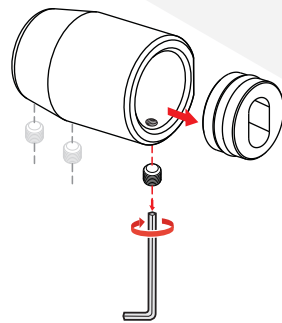

Provide thread-lock
glue (Loc-Tile)

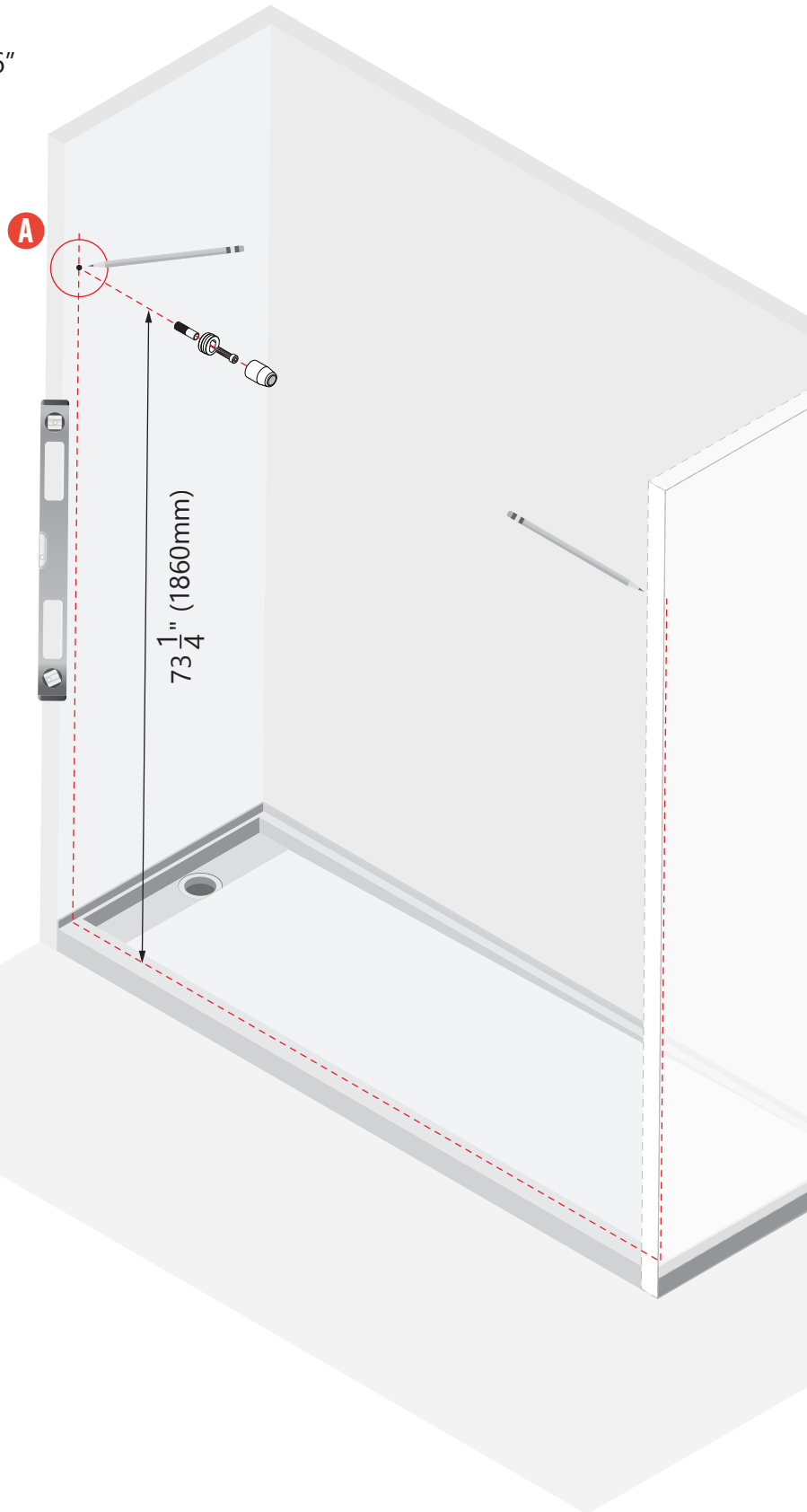

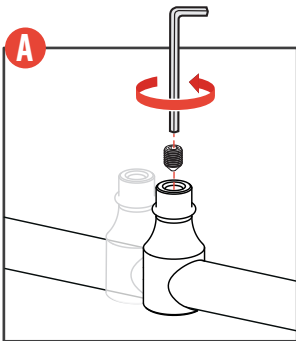
Step 2

A.1
Slide door stops
onto rod and
position accordingly

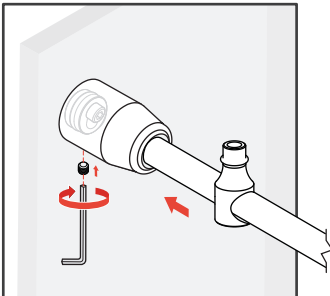

A.2
Tighten set screws
and secure with
loc-tite once rod is in
desired position

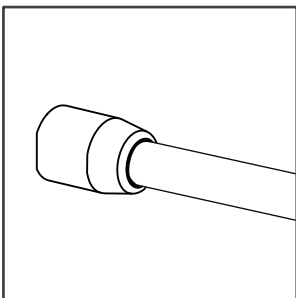

A.3
Make sure that the
flat side of rod
mount faces out to
allow glass panel
door to fully operate.

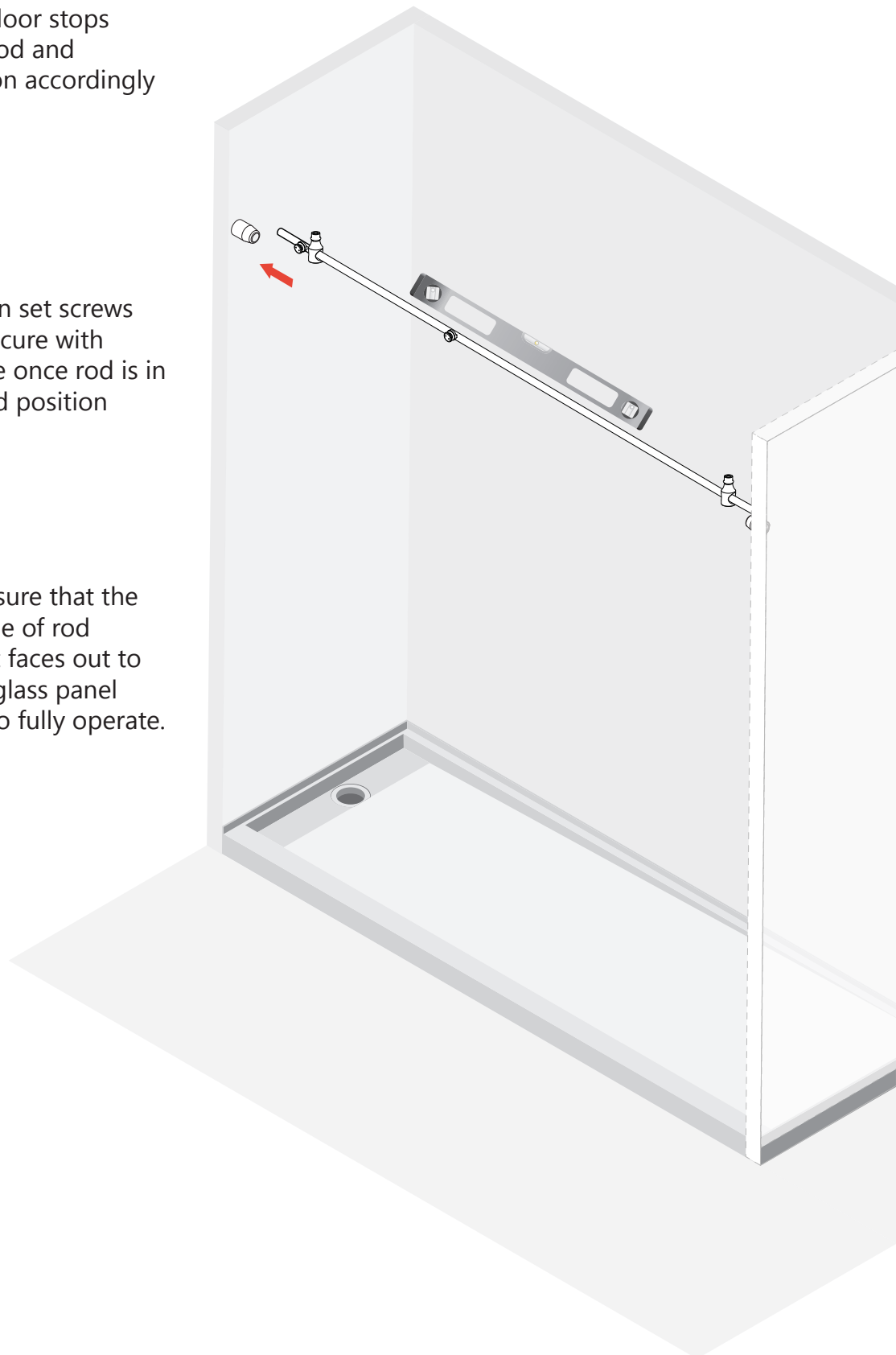

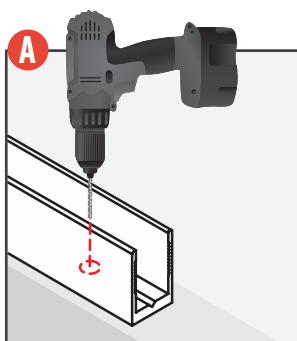
Step 3

A.1
Mark and drill holes

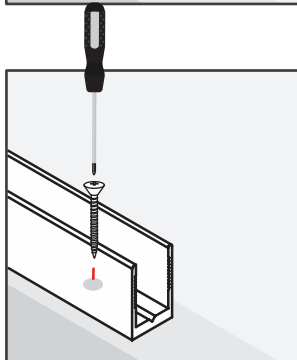

A.2
After mounting U-channel, silicone over the top of any fasteners used inside the channel prior to glass installation to seal any penetrations

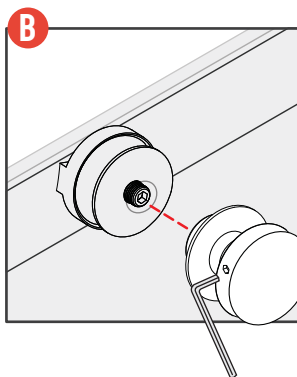

B.1
Mount fixed panel to brackets on rod

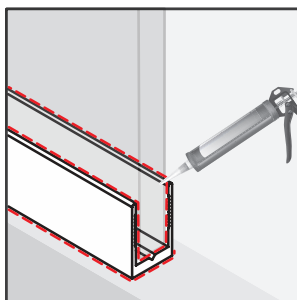

B.2
and drop panel into U-channel. Silicone both sides of the U-channel to the glass, and silicone the channel to the curb inside and out

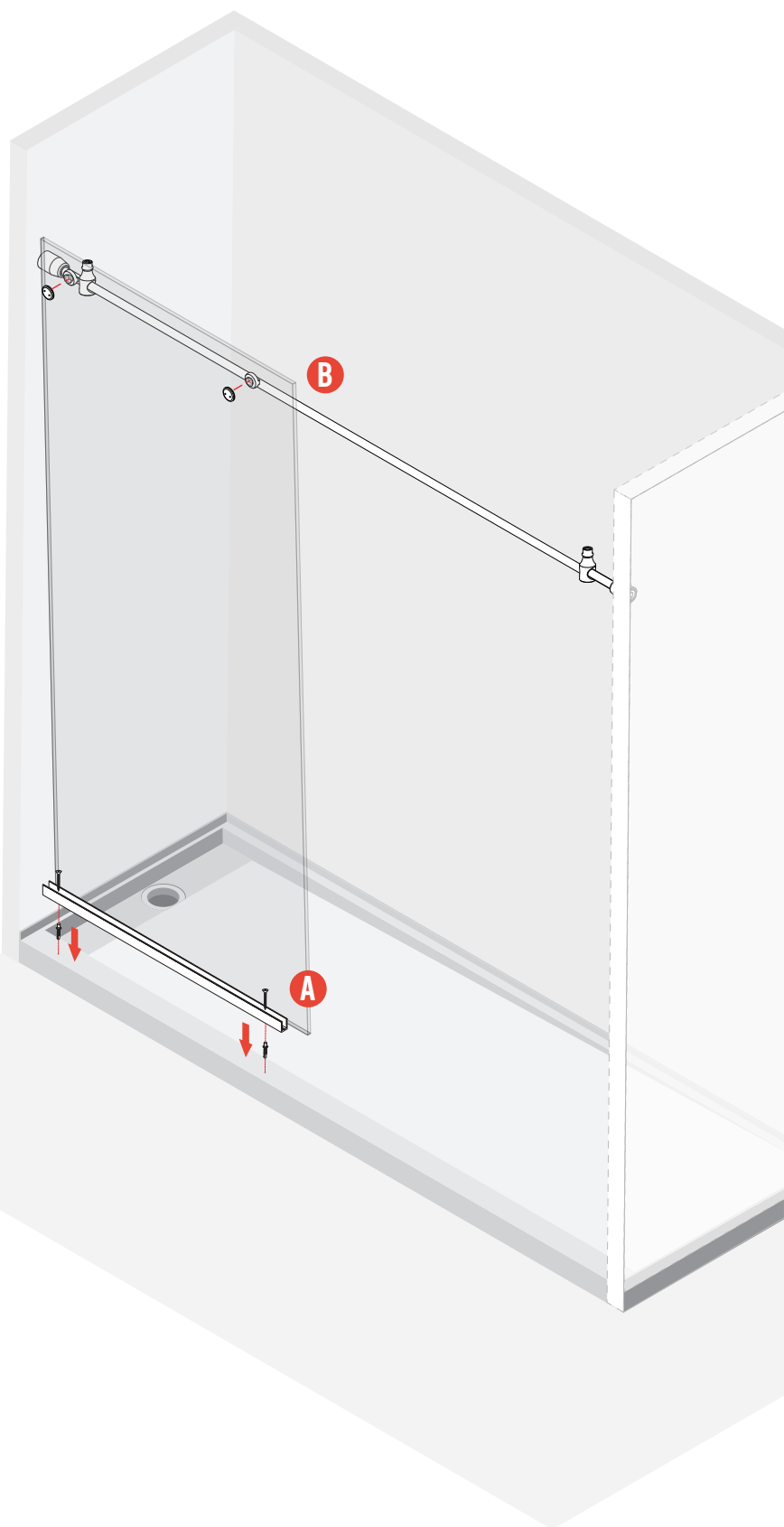

Step 4

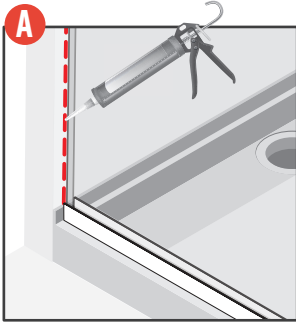

A.1
Silicone glass to wall on vertical edge.

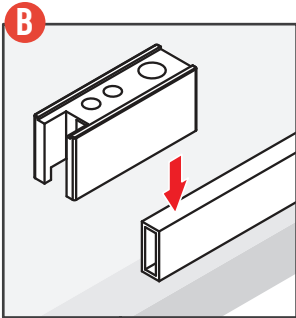
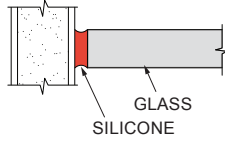

B.1
Insert rollers on to rails as pictured before attaching to glass doors.

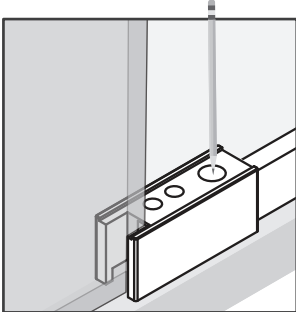

B.2
Water dam is recommended for optimal performance. The sliding door must be installed to the interior of the shower in order to use it

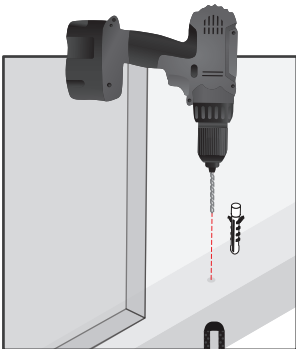

B.3
Drill holes and insert anchor

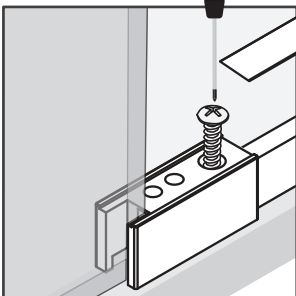

B.4
Insert screw and silicone over the top of fastener to seal any penetrations. Apply cover

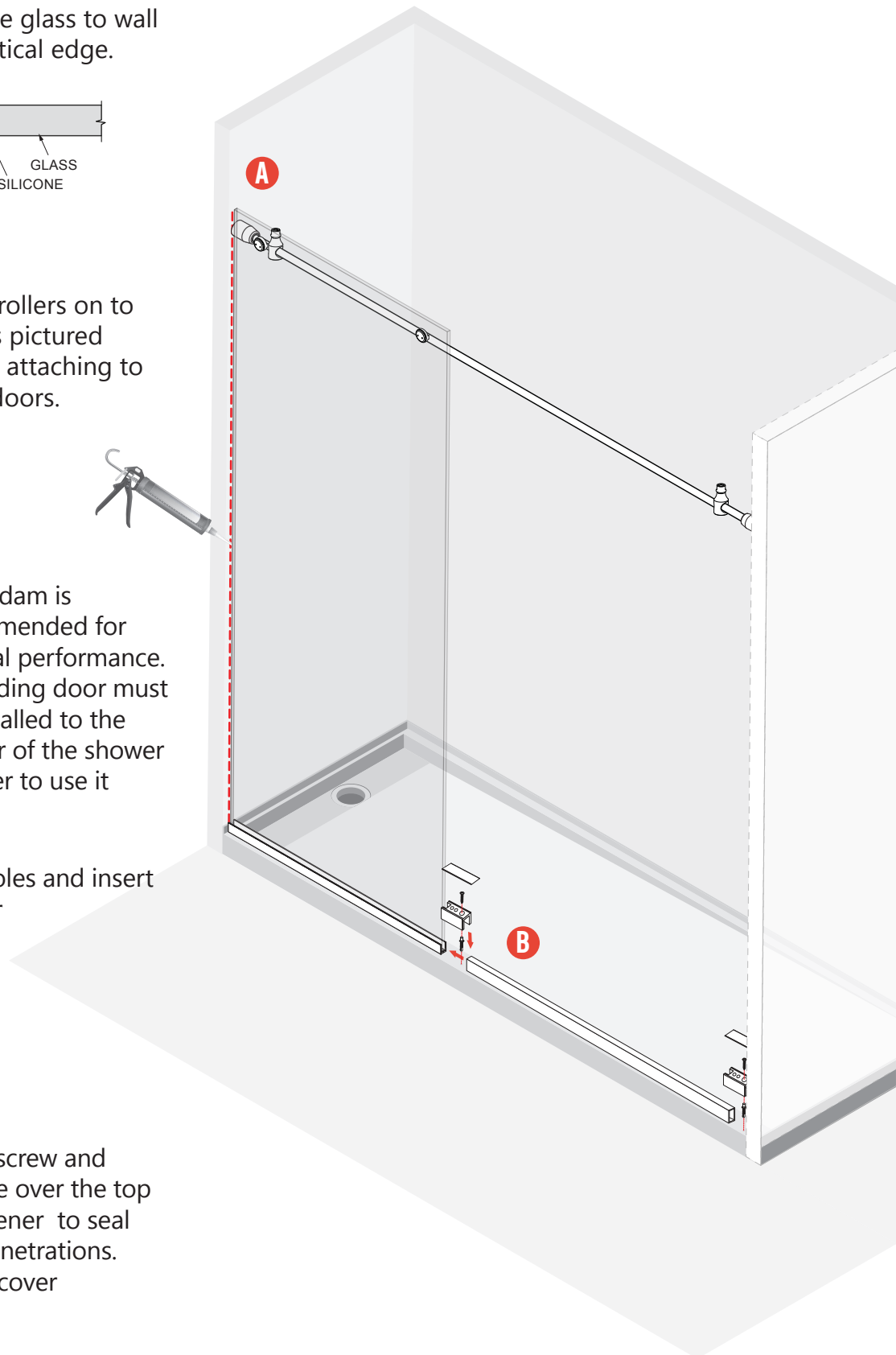

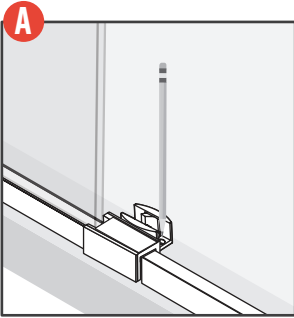
Step 5**A.1**

Floor guide goes inside of the water dam and U-channel. Place and mark holes

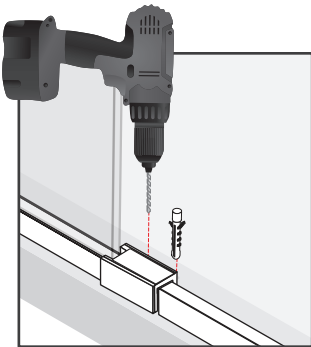
**A.2**

Drill holes and insert anchors for screws

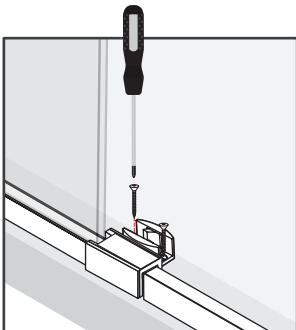
**A.3**

Mount floor guide and silicone over the top of fastener to seal any penetrations

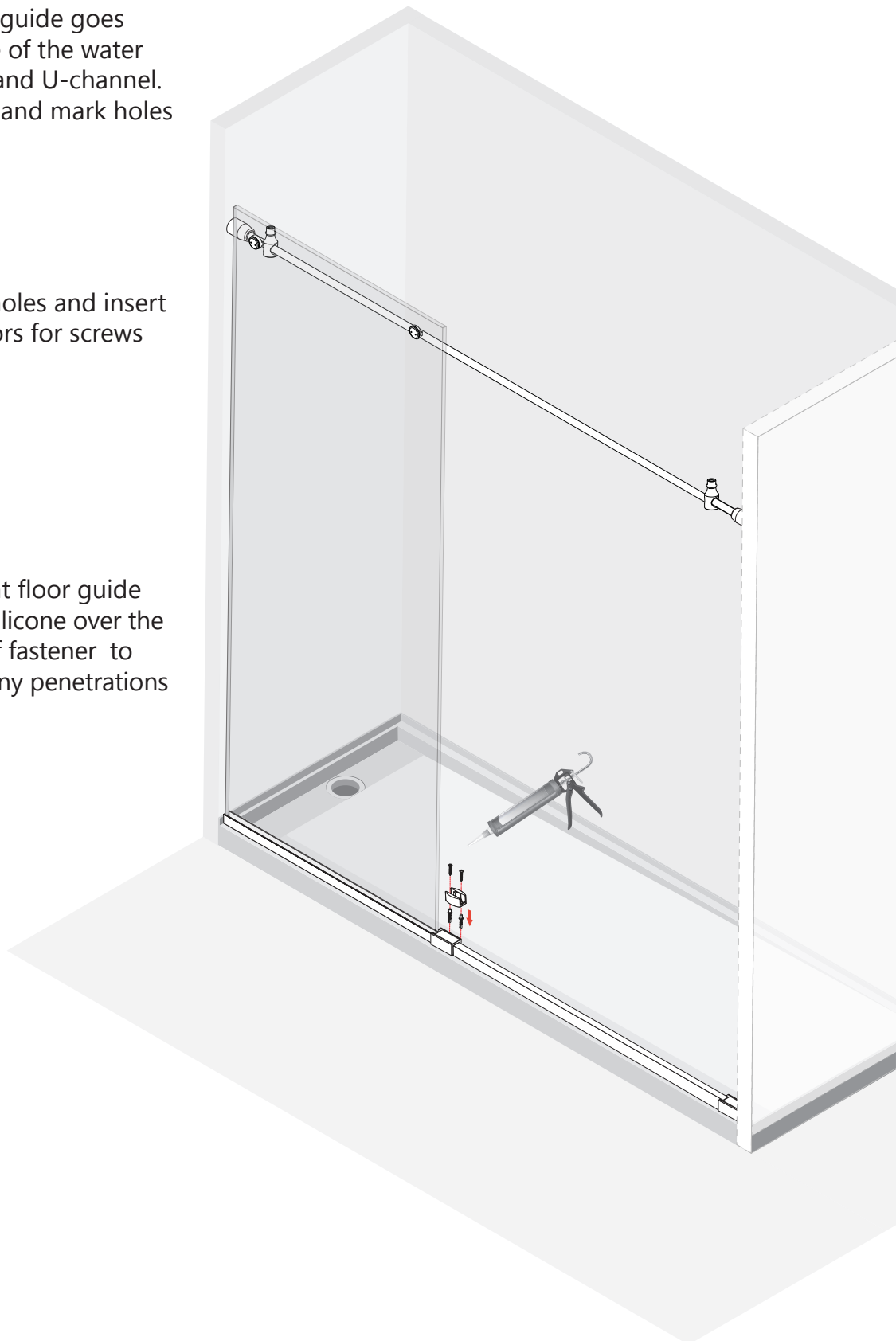

Step 6

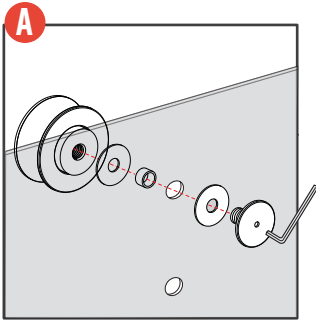

A.1

The four barn door trolleys include an offset grommet held in by a pin. This grommet will allow you to adjust the vertical and horizontal plumb about 1/4", by twisting the back side of the trolley.

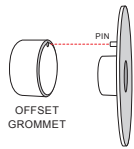

! Attention:
Take care not to break off the pin

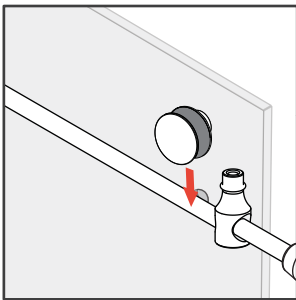

A.2

Hang glass door onto rod

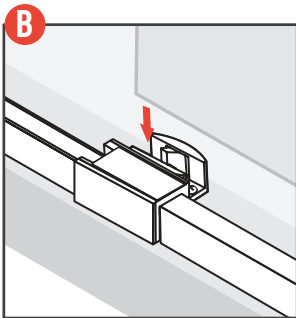

B.1

Align bottom guide to allow glass to run in a plumb condition

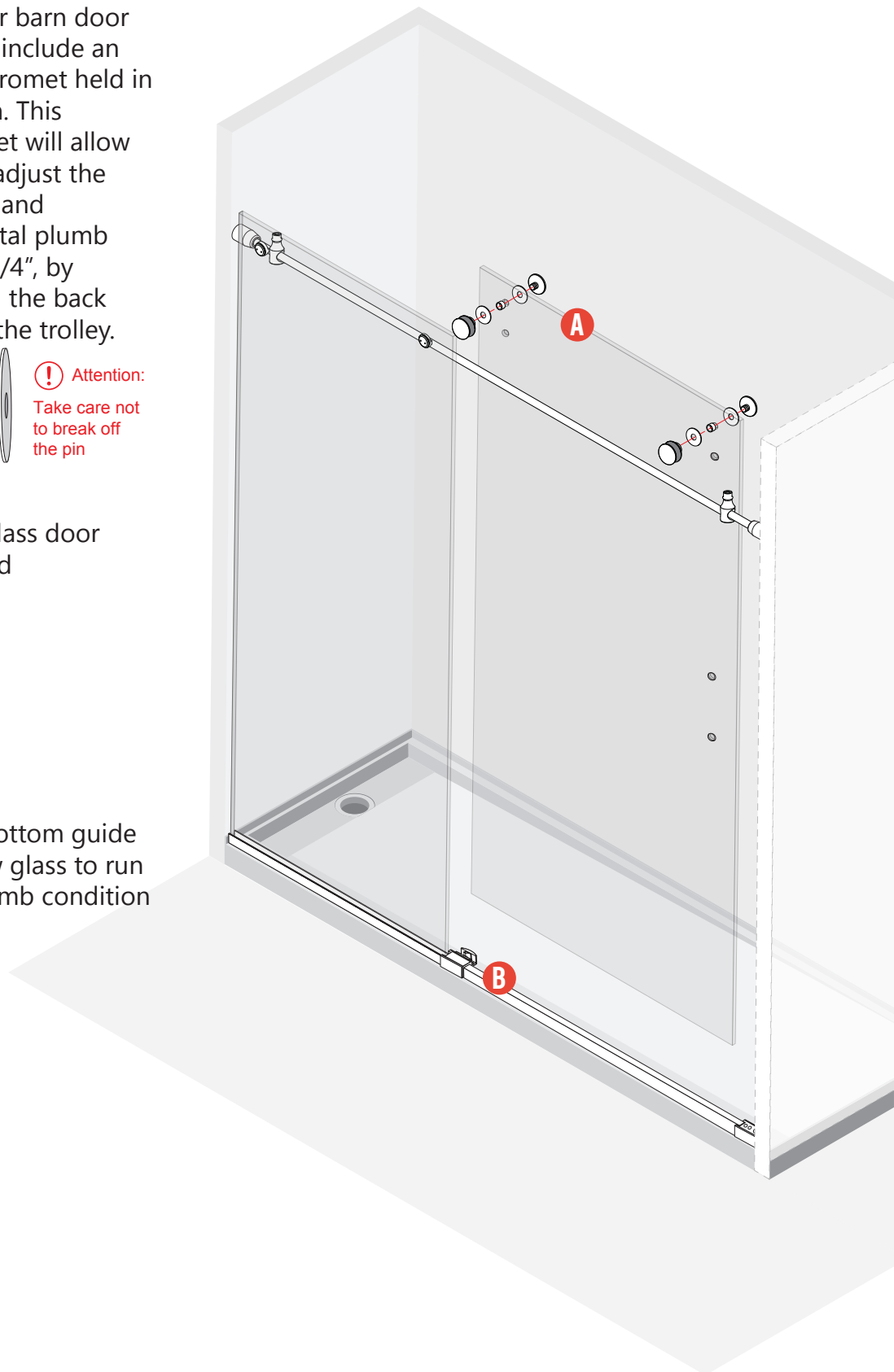

Step 6

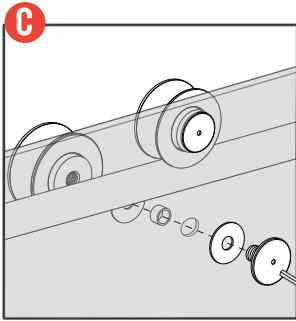

C.1
Install the bottom rollers using the same steps as the top

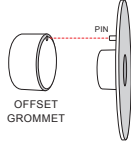

! Attention:
Take care not to break off the pin

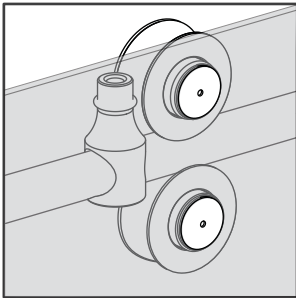

C.2

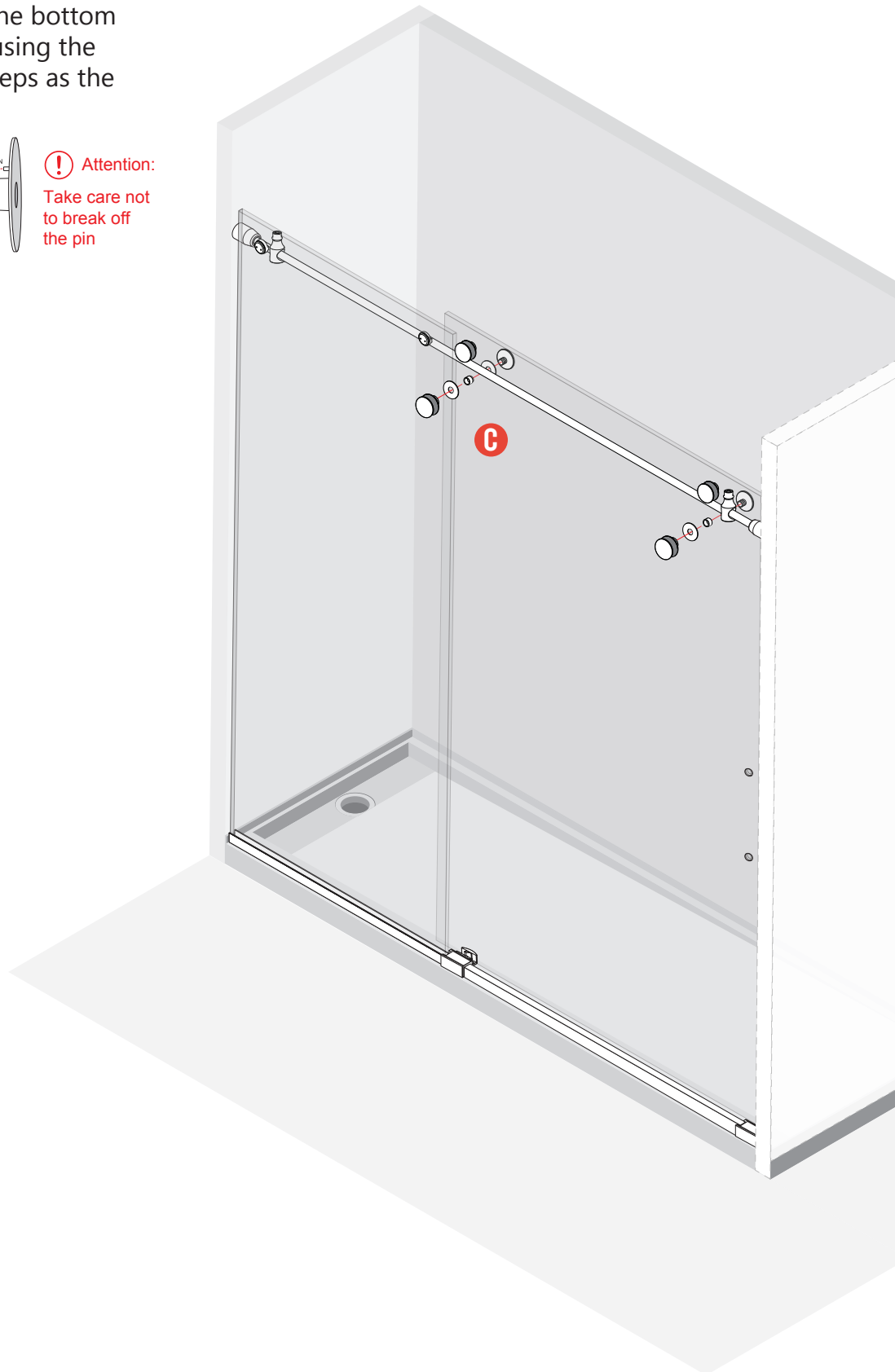

Step 7

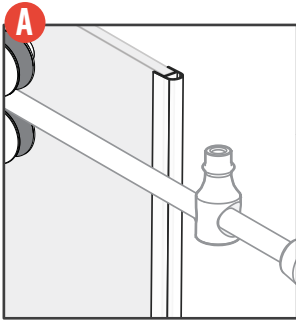

A.1
Apply seal to glass door

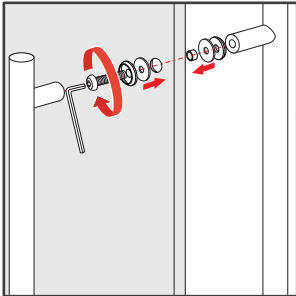

B.1
Install BTB pull

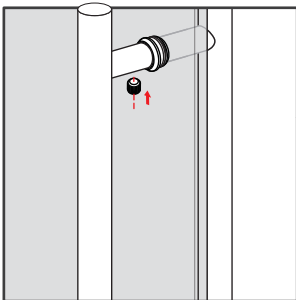

B.2
Install BTB pull

